

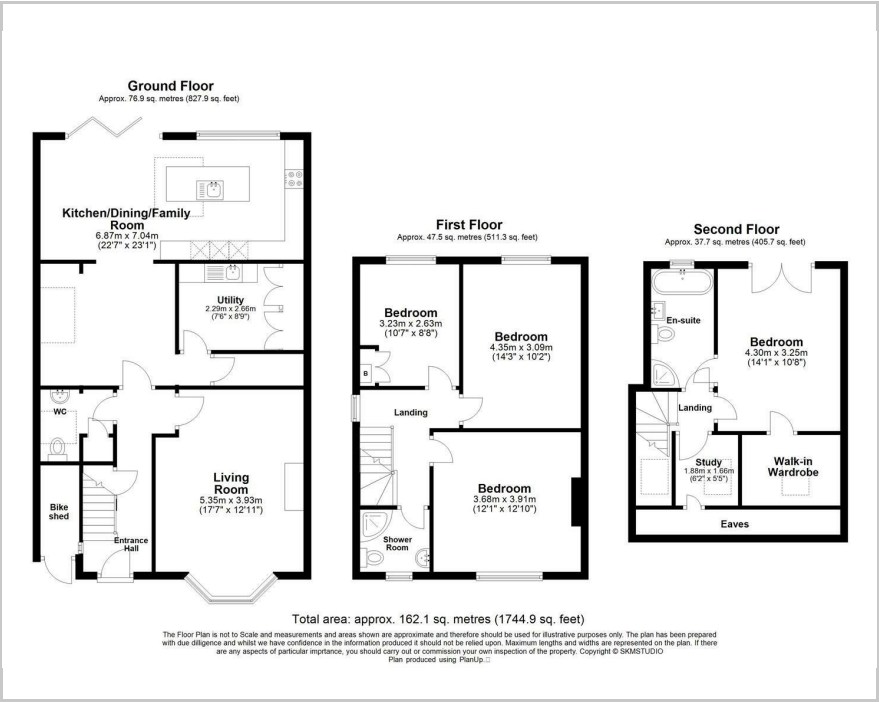

14 Dickinson Avenue, Croxley Green, WD3 3EX
Price Guide £1,175,000



Floor Plan



Area Map

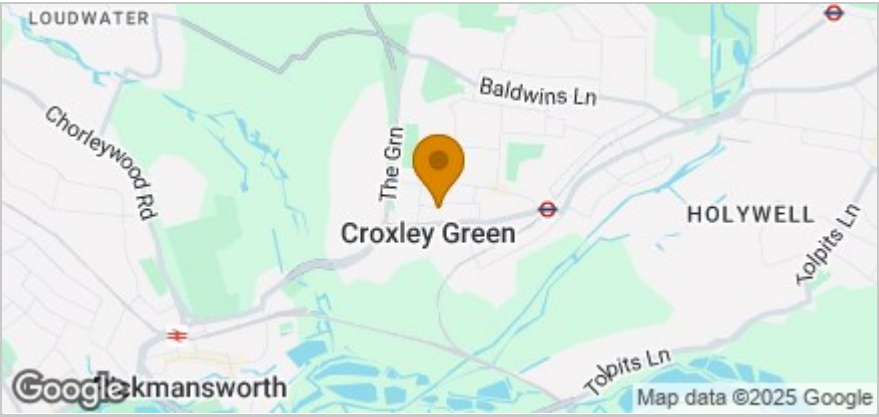

Accommodation

- Stunning 4/5 Bed extended detached family home with large garden
- Master Bed with Juliet balcony, walk in wardrobe and large En-Suite
- Open plan Kitchen/Dining/Family room
- Separate front Reception room, Utility room and a W.C.
- Short walk to Rickmansworth School and Met Line station
- Central village location

Viewing

Please contact our Grosvenor Estate Agents Ltd Office on 01923 711651 if you wish to arrange a viewing appointment for this property or require further information.

Energy Efficiency Graph

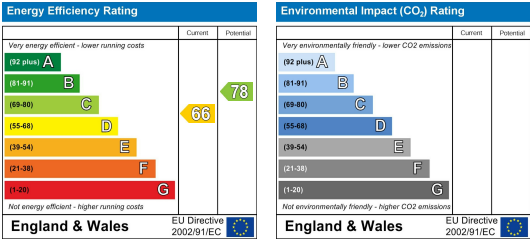

These particulars, whilst believed to be accurate are set out as a general outline only for guidance and do not constitute any part of an offer or contract. Intending purchasers should not rely on them as statements of representation of fact, but must satisfy themselves by inspection or otherwise as to their accuracy. No person in this firms employment has the authority to make or give any representation or warranty in respect of the property.